

CAPSULORHEXIS - DEEP SCLERECTOMY - INTRAOCULAR FORCEPS

KANSAS

4.4468 Nucleus fragment removal forceps, angled, 9 mm jaws, 12.0 cm



UTRATA-KERSHNER

Capsulorhexis forceps, angled, very delicate, grasping tips, and extremely thin 11 mm long shanks, 10 cm

4.4469 Flat handle 10 cm

4.4470 Round handle 10.5 cm

4.4471 Ergonomic handle 10.5 cm



MASKET

4.4472 Capsulorhexis-Cystotome, curved, ergonomic Forceps 10.5 cm



KERSHNER

4.4473 Micro capsulorhexis forceps 20 G



GALAND-UTRATA

4.4474 Capsulotomy-cystotome forceps for anterior and posterior capsulorhexis 13.0 mm jaws, 8.0 cm

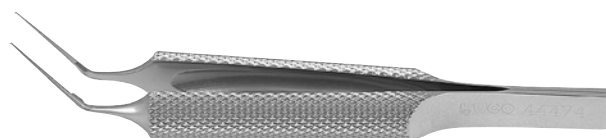

MERMOUD

4.4475 Non penetrating filtering surgery forceps to hold the scleral and corneal stroma tissue 13.0 mm jaws, 8.5 cm

3.4475 Titanium



Intraocular forceps

4.4480 Straight smooth jaws

4.4482 Straight serrated jaws

4.4486 Straight cup jaws

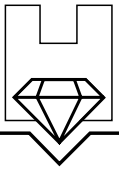

LENS AND IOL FORCEPS

ARON

- 4.4500 Lens holding
forceps, angled
- 4.4506 With peg



ARRUGA

- 4.4501 Capsule forceps,
curved



ARRUGA

- 4.4502 Capsule forceps,
new curve



BLAYDES

- 4.4503 Lens holding
forceps, curved
very delicate



CLAYMAN

- 4.4504 Lens holding
forceps, curved



SHEPARD

- 4.4505 Lens holding
forceps,
curved

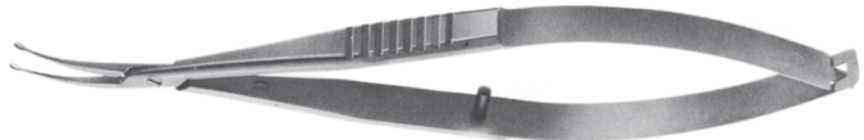

HUCO

- 4.4511 IOL folding forceps
to hold the lens, to be grasp
between the slit of the jaws,
11.0 cm



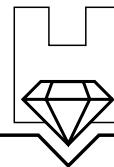

SOFT IOL FORCEPS

SPALECK

4.4512 Soft IOL inserting forceps
15.0 mm very fine jaws, 10 cm



HUCO

4.4514 IOL fine holding forceps while folding, very fine smooth jaws
13.0 mm, 9.0 cm



GALAND-BARRETT

4.4516 Soft IOL folding forceps, w/grooved jaws
1.0 mm, 11 cm



GALAND-PAUFIQUE

4.4517 Holding and inserting foldable IOL forceps, platform
0.8 mm/11.0 mm, straight, 8.5 cm



HUCO

4.4518 Inserting forceps for silicone IOL, flat jaws, 11.5 cm

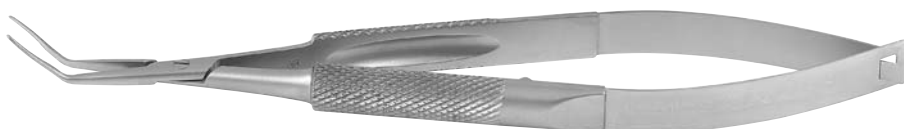

HUCO

4.4519 Inserting forceps for acrylic IOL, round high polished jaws, 11.5 cm

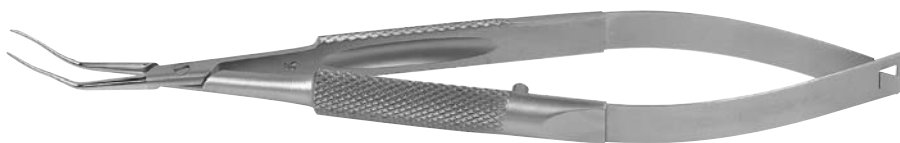

GALAND-NORDAN

4.4520 Folding forceps for 5.5 mm silicone and acrylic IOL with lock, 11.0 cm

